

LOC	REV	REVISIONS		
AD	47	F	REVISED PER ECO-11-005033	29MAR11
		LW		RK
		S2		HMR

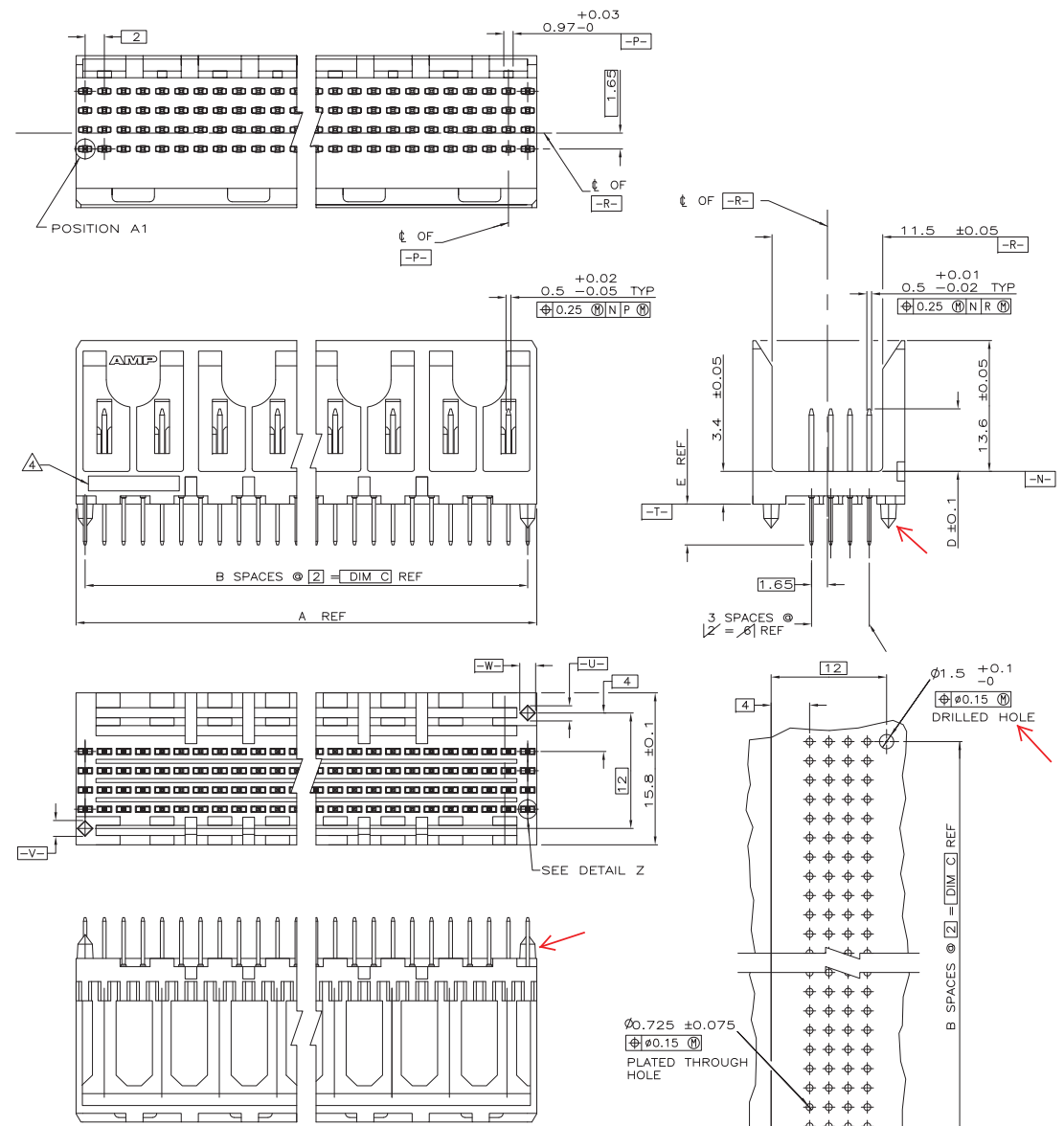

- △ HOUSING MATERIAL: LIQUID CRYSTAL POLYMER PER ASTM D5138 LCP000 G30A 32250.
- △ CONTACT MATERIAL: PHOSPHOR BRONZE.
- △ CONTACT FINISH:  
 UNDERPLATE (ENTIRE CONTACT):  
 0.00127 MIN NICKEL.  
 ON MATING SURFACES:  
 CONFORMS TO ALL TESTING SPECIFIED FOR TELCORDIA  
 UNCONTROLLED ENVIRONMENT.  
 ON LEADS:  
 0.00381 MIN TIN-LEAD OVER UNDERPLATE.  
 LUBRICATION (ENTIRE CONTACT):  
 SURFACE CONDITIONER PER AMP SPEC 112-1002 AFTER PLATING.
- △ PART MARKING PER AMP INCORPORATED SPECIFICATION 115-9009, LOCATED  
 APPROXIMATELY AS SHOWN.
- △ OBSOLETE PARTS: OBSOLETE CIS STREAMLINING PER D.RENAUD/D.SINISI

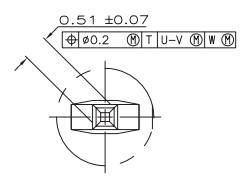

DETAIL Z  
 SCALE 20:1

RECOMMENDED CIRCUIT PATTERN  
 PER IPC-D300 TYPE II, CLASS C  
 (COMPONENT SIDE)

4.25	6.5	46	23	47.88	△	96	536501-3
E	D	C	B	A	FINISH	NO OF POSN	PART NUMBER

THIS DRAWING IS A CONTROLLED DOCUMENT:		BY	DATE	TE Connectivity
DRAWN		D.R.BENDORF	08/08/92	
CHECKED		R.BENDORF	08/14/92	Z-PACK 2mm FB, SIGNAL MODULE, PIN ASSEMBLY 2mm
APPROVED		R.BENDORF	08/14/92	
DIMENSIONS:		TOLERANCES UNLESS OTHERWISE SPECIFIED:		APPLICATION SPEC
mm	mm	mm	mm	mm
Ø	±	±	±	±
mm	mm	mm	mm	mm
mm	mm	mm	mm	mm
mm	mm	mm	mm	mm
MATERIAL:	FINISH:	WEIGHT:	SIZE	DATE CODE
△	△	△	A1	00779
CUSTOMER DRAWING		SCALE	DRAWING NO	REV
		4:1	536501	1