

Notes: (Unless Otherwise Specified).

1) DIMENSIONS: inch [mm]

2) PLATING:

Ni 80 MICRO-INCH (2.0µm) MIN

Au 60 MICRO-INCH (1.5µm) MIN

3) SINGLE PART TYPE

4) SEAL RING AND DIE PAD TO BE ISOLATED

APPROVALS		DATE				
DRAWN	T. Au	4/15/2023				
ENG	M. Hart	4/15/2023	LCC8B50R.17x.25-N LEADLESS CHIP CARRIER			
MFG			SCALE	SIZE	DRAWING NO.	REV
QA			10:1	A	130800	A
CUST			DO NOT SCALE DRAWING			SHEET 1 OF 5
REVISED						

DETAIL A  
BOND PADS

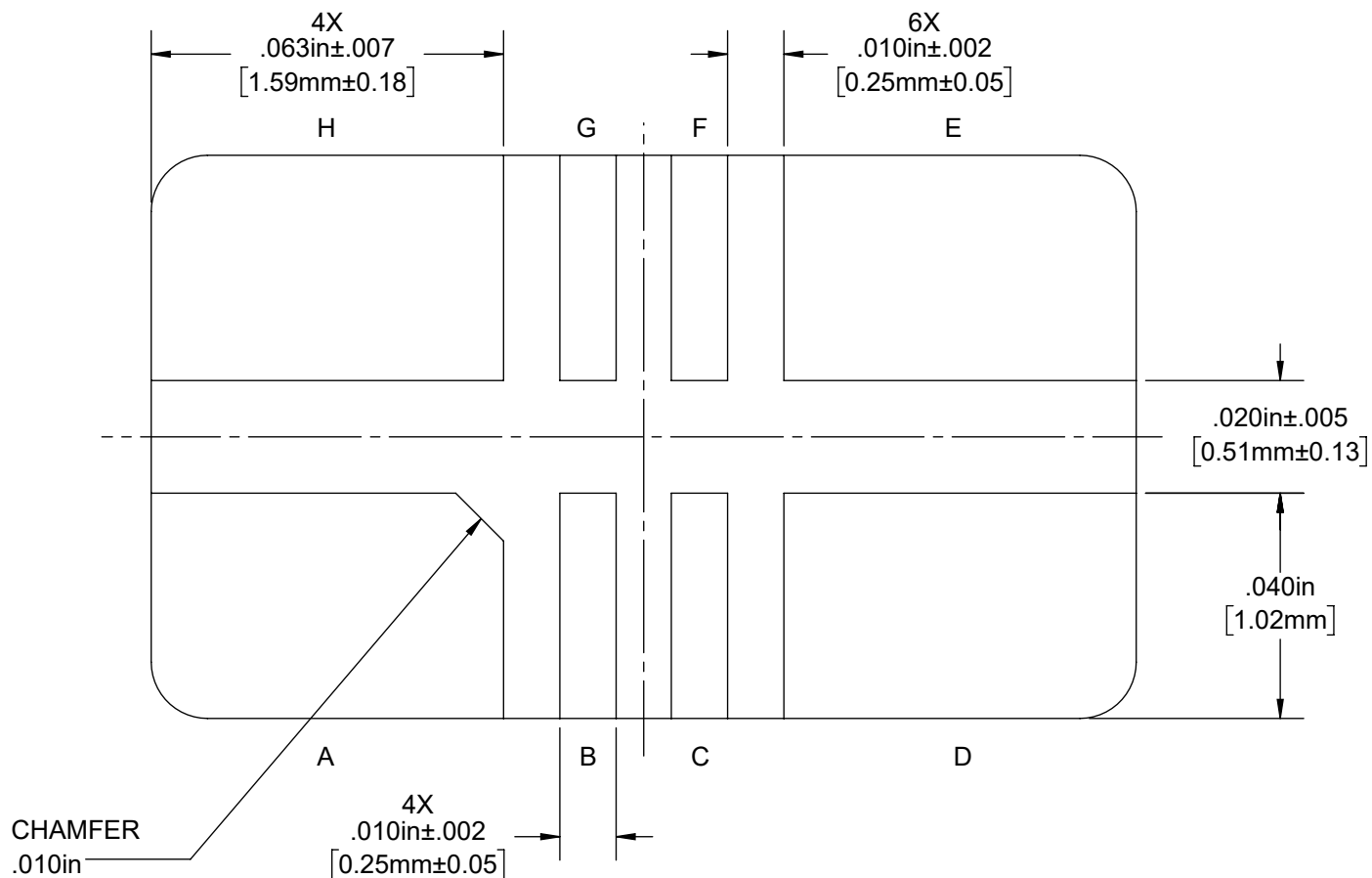

CONNECTION TABLE

PAD A to PIN 1
PAD B to PIN 2
PAD C to PIN 3
PAD D to PIN 4
PAD E to PIN 5
PAD F to PIN 6
PAD G to PIN 7
PAD H to PIN 8

NO PIN CONNECTED  
TO SEAL RING AND  
DIE PAD. ZERO GROUND

NOTES:

- 1) DIMENSIONS: Inch [mm]
- 2) BOND PADS ALLOWED WITH OR WITHOUT METALIZATION AT THE EDGE OF THE CAVITY M-1 PATTERN

**TopLine**<sup>®</sup>

TITLE LCC8B50R.17x.25-N  
LEADLESS CHIP CARRIER

SCALE 30:1	SIZE A	DRAWING NO. 130800	REV A
---------------	-----------	-----------------------	----------

DO NOT SCALE DRAWING

SHEET 2 OF 5

# MODELS

TOP

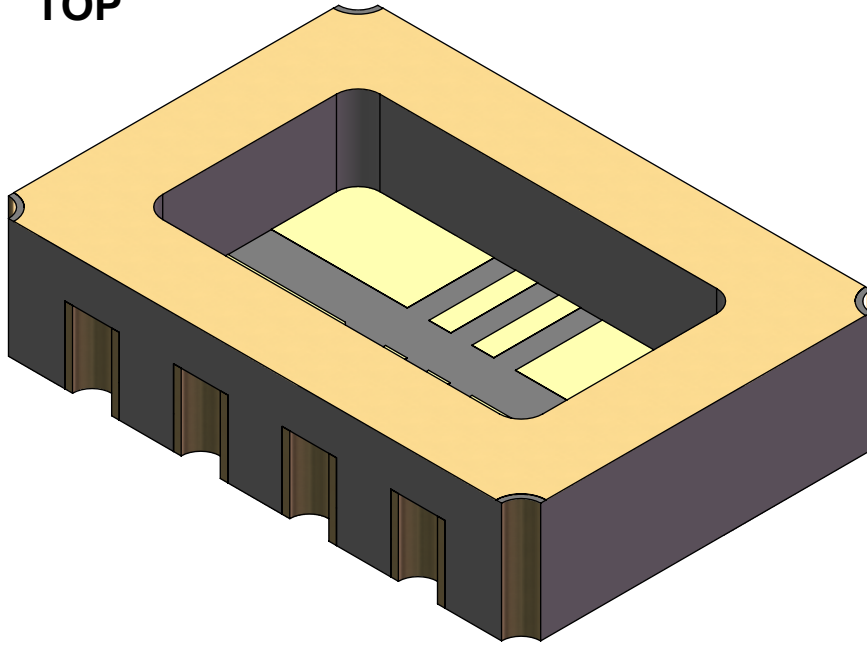

BOTTOM

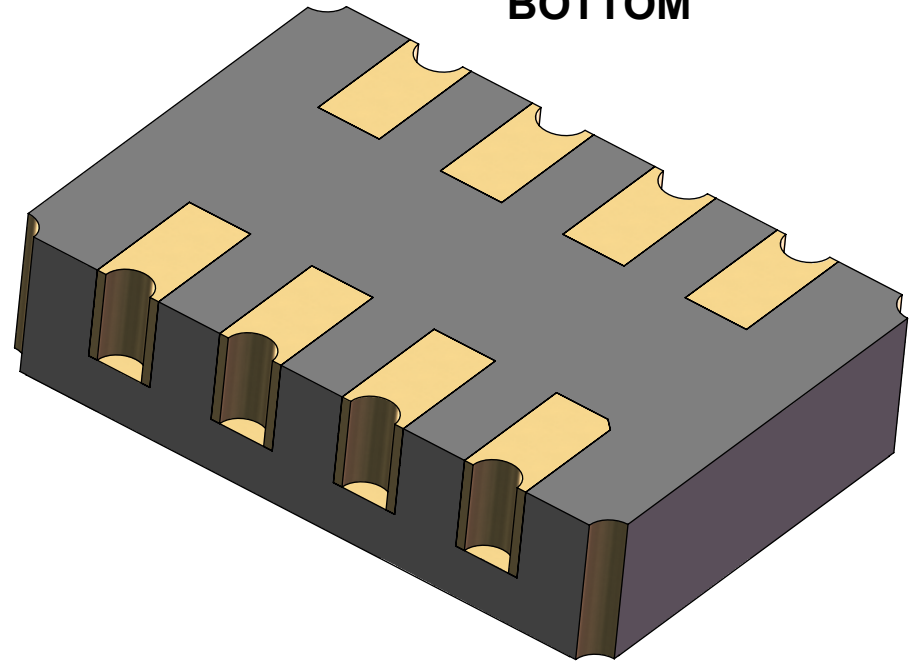

**TopLine®**

TITLE LCC8B50R.17x.25-N  
LEADLESS CHIP CARRIER

SCALE	SIZE	DRAWING NO.	REV
30:1	A	130800	A

DO NOT SCALE DRAWING

SHEET 3 OF 5

# COMBO LID (OPTIONAL #1)

## BOTTOM

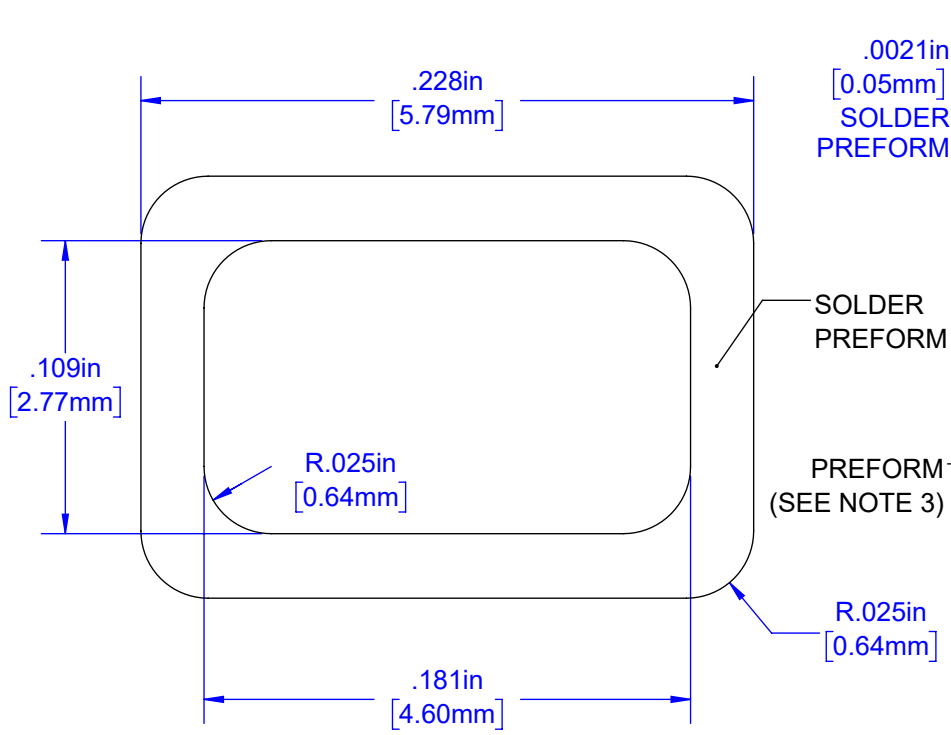

## SIDE

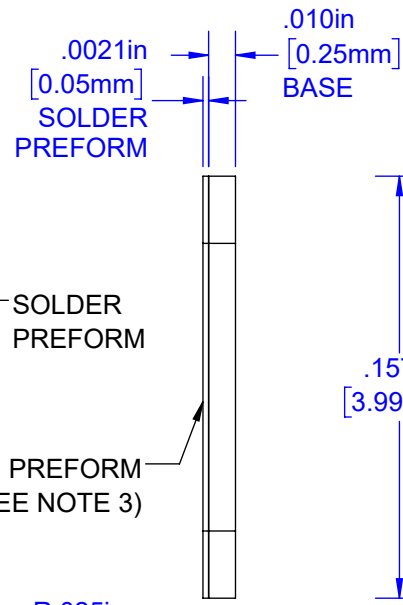

## TOP

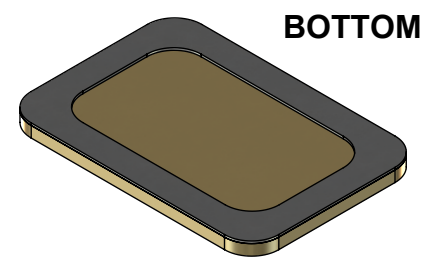
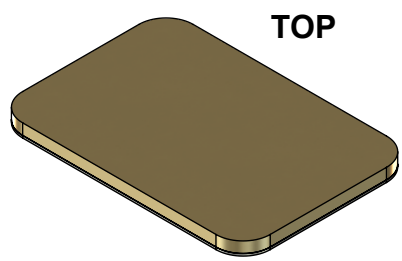
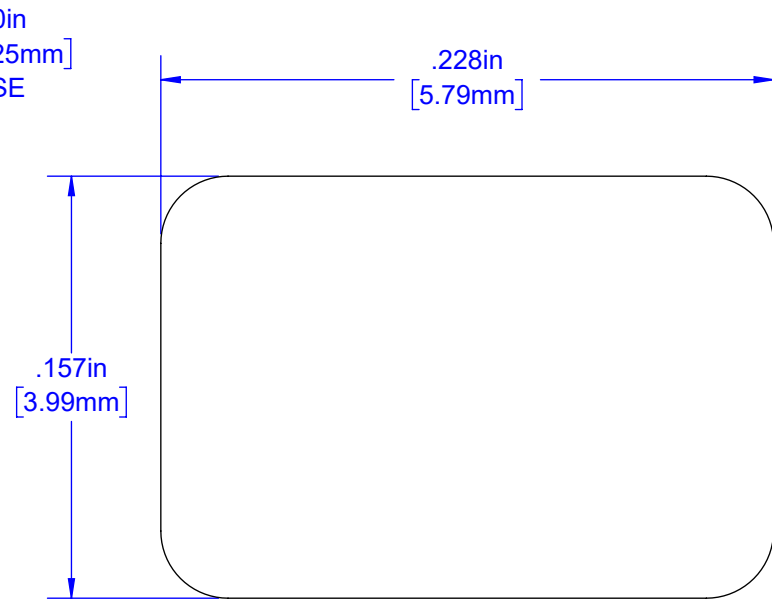

### NOTES:

1. BASE MATERIAL: KOVAR or ALLOY 42
2. PLATING: Ni 50~350 MICRO-INCH PER SIDE  
Au 25 MICRO-INCH PER SIDE
3. SOLDER PREFORM: Au 80% ± Sn20%
4. FLATNESS 1.0 MIL (25µm) MAXIMUM PER 0.5-inch (12.7mm)
5. DIMENSIONS: inch [mm]

### MODEL

REF W1238H

<b>TopLine®</b>			
TITLE		CL-228x157-A COMBO LID	
SCALE	SIZE	DRAWING NO.	REV
14:1	A	130800	A
DO NOT SCALE DRAWING			SHEET 4 OF 5

# COMBO LID (OPTIONAL #2)

**BOTTOM**

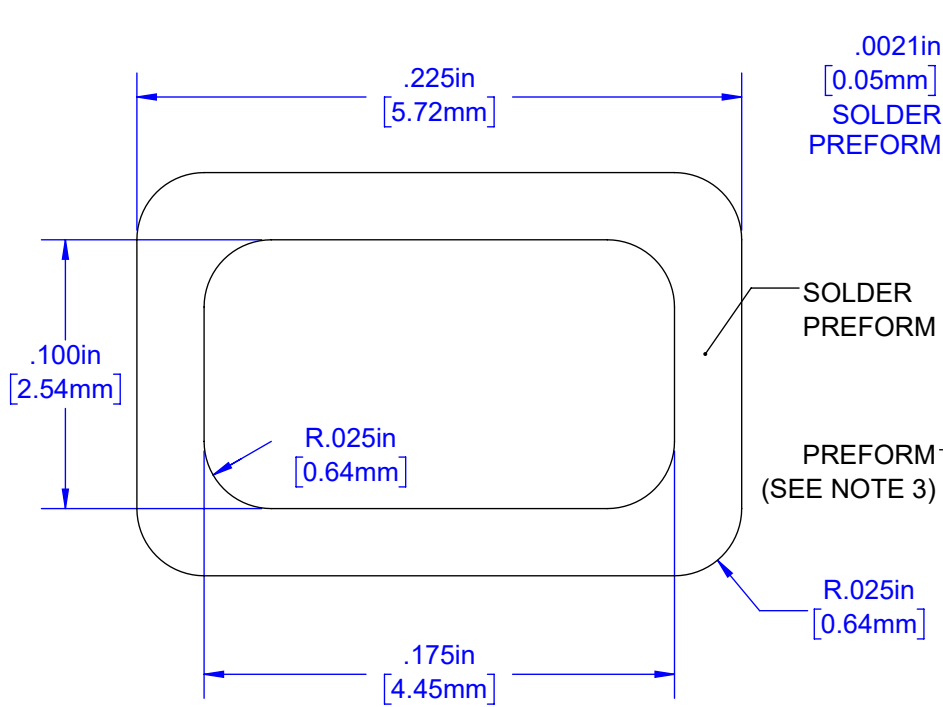

**SIDE**

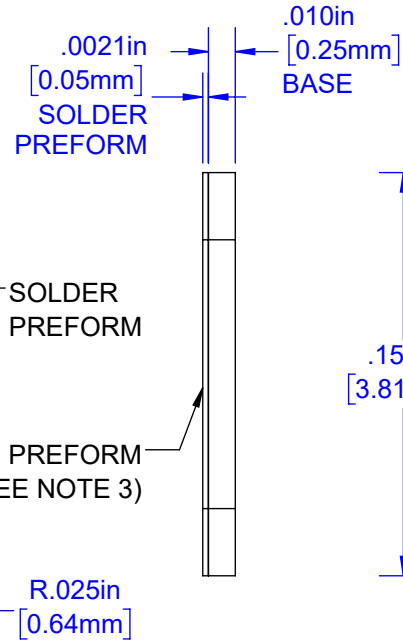

**TOP**

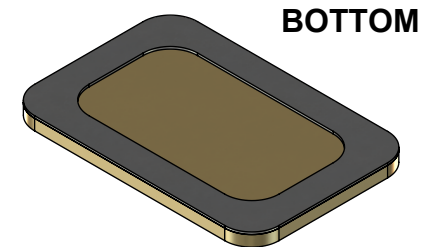
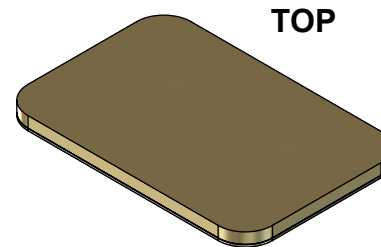
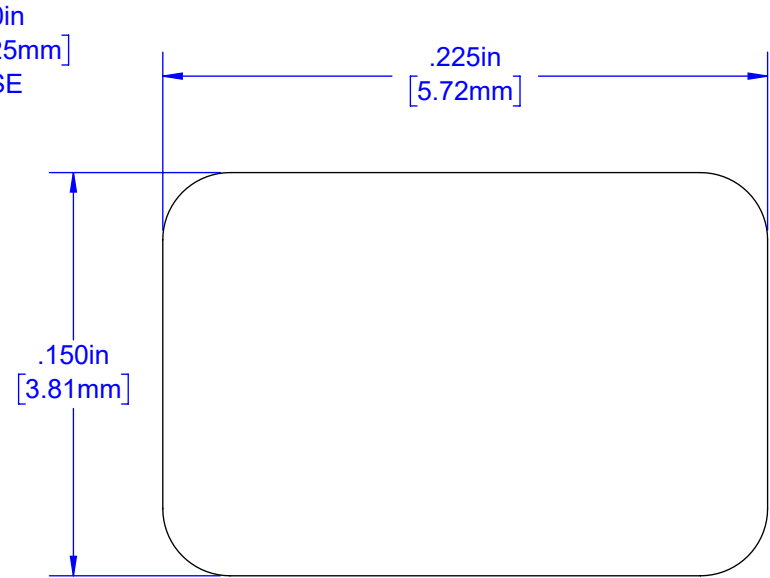

**NOTES:**

1. BASE MATERIAL: KOVAR or ALLOY 42
2. PLATING: Ni 50~350 MICRO-INCH PER SIDE  
Au 25 MICRO-INCH PER SIDE
3. SOLDER PREFORM: Au 80% ± Sn20%
4. FLATNESS 1.0 MIL (25µm) MAXIMUM PER 0.5-inch (12.7mm)
5. DIMENSIONS: inch [mm]

**MODEL**

REF HR-C-2061

<b>TopLine®</b>			
TITLE		CL-225x150-A COMBO LID	
SCALE	SIZE	DRAWING NO.	REV
14:1	A	130800	A
DO NOT SCALE DRAWING			SHEET 5 OF 5