

TOP VIEW

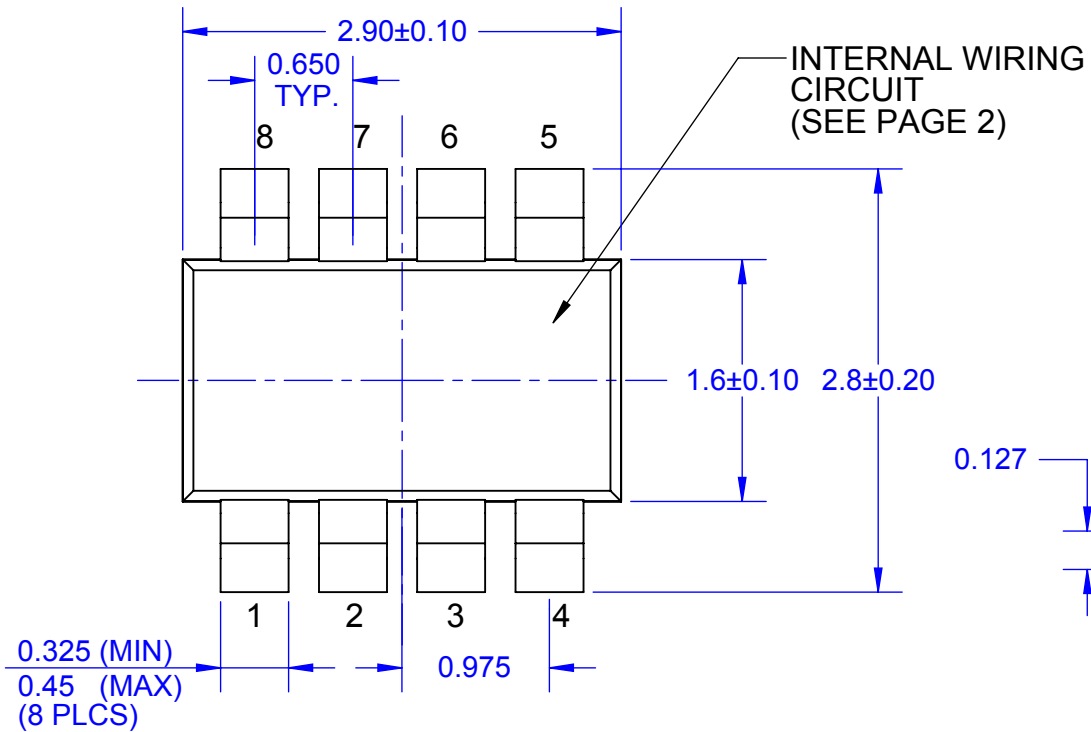

**DETAIL A
SCALE 40 : 1**

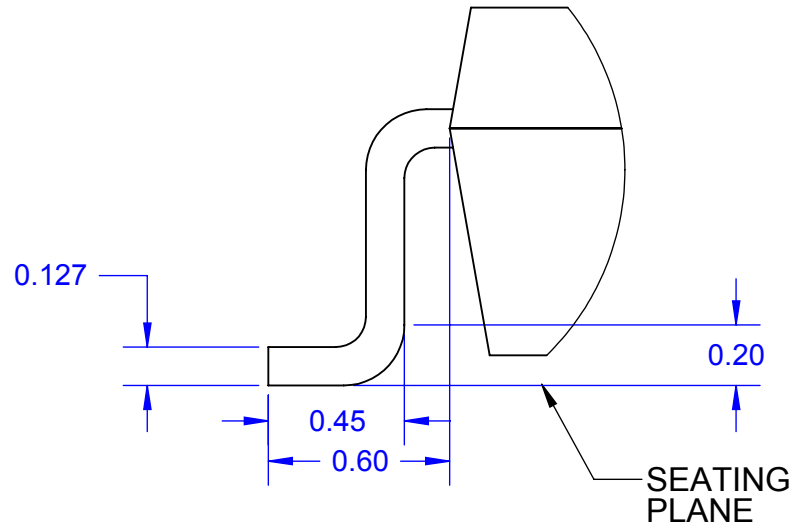

SIDE VIEW

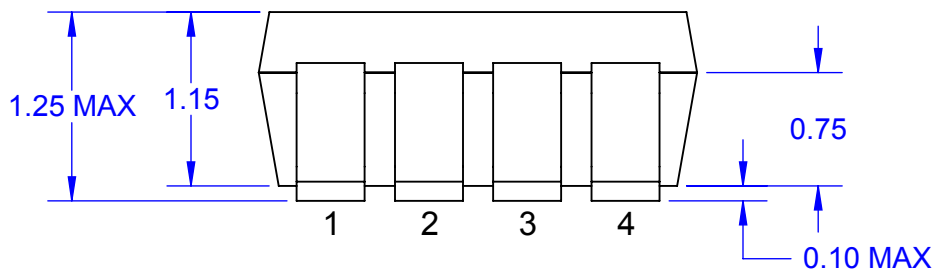

END VIEW

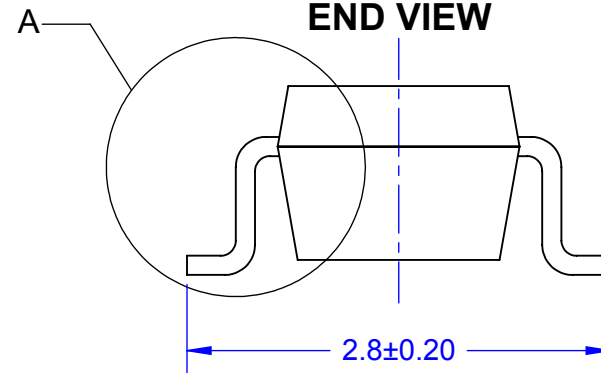

Notes: (Unless Otherwise Specified).

- 1) DIMENSIONS IN mm.
- 2) SEE DAISY CHAIN JUMPER DIAGRAMS (PAGE 2).
- 3) SEE PART NUMBER CONFIGURATION (PAGE 4).
- 4) RECOMMENDED PC BOARD LAYOUT PATTERN (PAGE 7).

APPROVALS	DATE	TopLine®			
DRAWN T. Au	7/25/13				
ENG M. Hart	7/25/13	TITLE SOT28 JUMPER DAISY CHAIN			
MFG		SCALE 20:1	SIZE A	DRAWING NO. 120028	REV A
QA		DO NOT SCALE DRAWING			SHEET 1 OF 8
CUST					
REVISED					

**INTERNAL WIRING CIRCUIT (JUMPER)
DAISY CHAIN PART NUMBER SUFFIX
TOP VIEW**

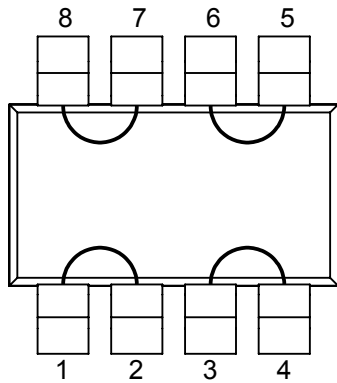

DC18

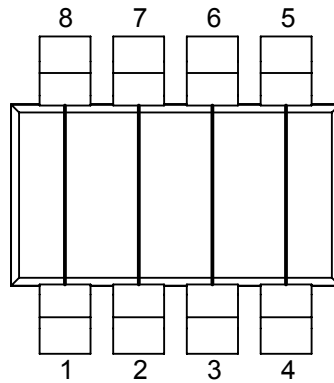

DC28

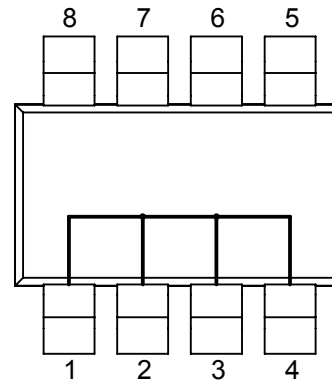

DC30

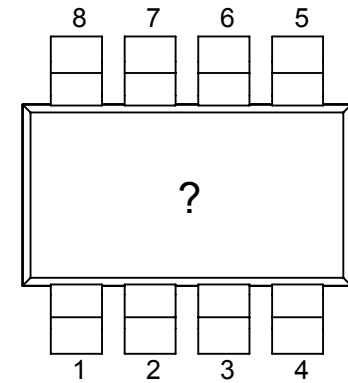

CUSTOM JUMPER
AVAILABLE

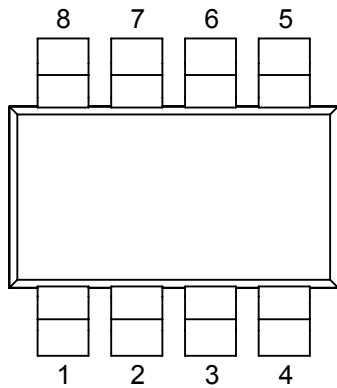

-ISO
NO WIRES
FULLY ISOLATED

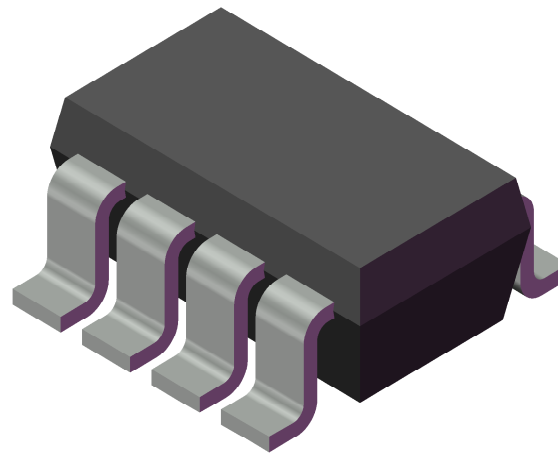

MODEL SCALE 20:1

TopLine®			
TITLE		SOT28 JUMPER DAISY CHAIN	
SCALE	SIZE	DRAWING NO.	REV
15:1	A	120028	A
DO NOT SCALE DRAWING			SHEET 2 OF 8

SCHEMATIC EQUIVALENT INTERNAL CIRCUIT

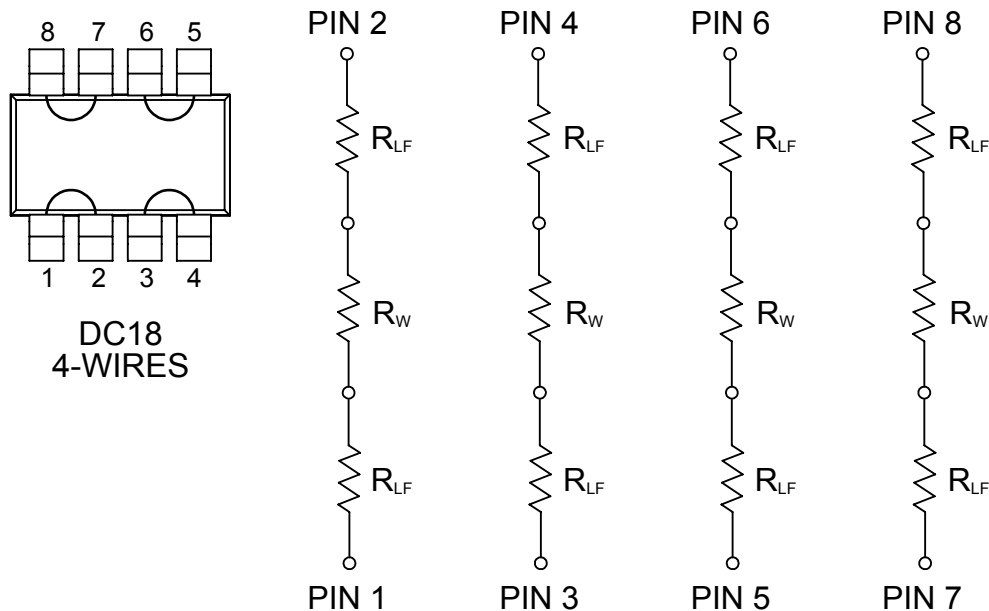

R_W = GOLD WIRE-BOND
 R_{LF} = LEAD FRAME

ELECTRICAL RESISTANCE MILIOHM (DC) MAX				
CIRCUIT	PIN 1 TO 2	PIN 3 TO 4	PIN 5 TO 6	PIN 7 TO 8
DC18	50 mΩ	50 mΩ	50 mΩ	50 mΩ

ELECTRICAL RESISTANCE MILIOHM (DC) MAX				
CIRCUIT	PIN 1 TO 8	PIN 2 TO 7	PIN 3 TO 6	PIN 4 TO 5
DC28	50 mΩ	50 mΩ	50 mΩ	50 mΩ

ELECTRICAL RESISTANCE MILIOHM (DC) MAX		
CIRCUIT	PIN 1-2-3-4	PIN 5-6-7-8
DC30	50 mΩ	NO CONNECTION

TEMPERATURE RATING	
JUNCTION TEMP T_j	150 °C
STORAGE TEMP T_{stg}	-65 °C TO 150 °C
OPERATING TEMP	-65 °C TO 150 °C
PEAK REFLOW TEMP T_{reflow} 10 SECONDS	260 °C

MAXIMUM ELECTRICAL (DC) RATING	
WORKING VOLTAGE	75 V
CURRENT RATING	100 mA
POWER @ 25 °C	350 mW

THERMAL RESISTANCE	
JUNCTION TO AMBIENT ($T_a=25^\circ$) $R_{th(j-a)}$	350K/W

TopLine®

TITLE		SOT28 JUMPER DAISY CHAIN		
SCALE	SIZE	DRAWING NO.	REV	
10:1	A	120028	A	
DO NOT SCALE DRAWING			SHEET 3 OF 8	

PART NUMBERING SYSTEM

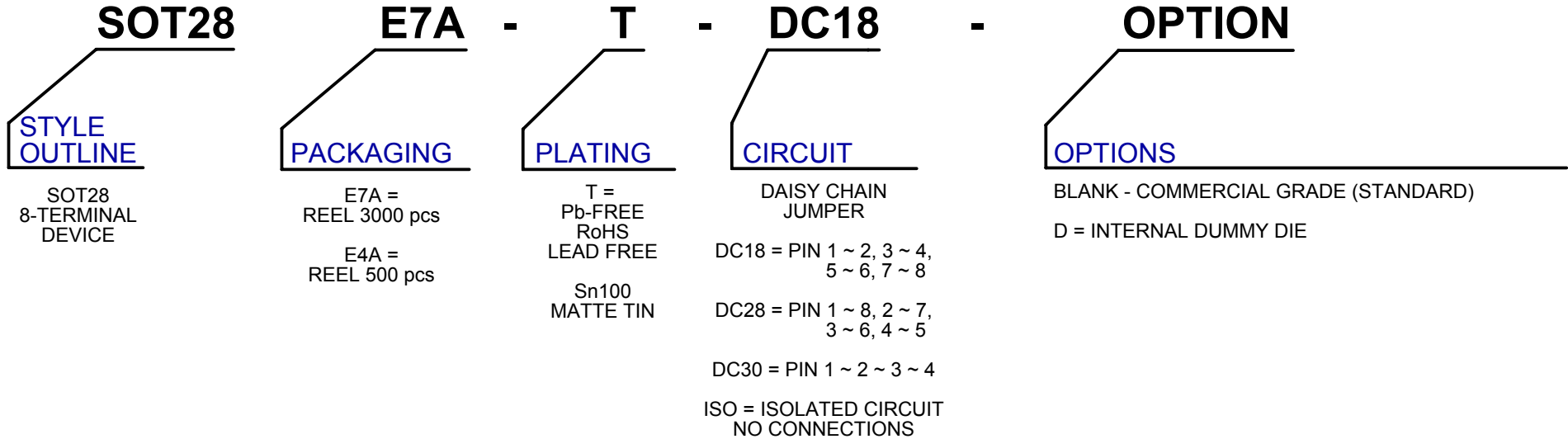

PART NUMBER	SHORTED PINS	NOTES	RoHS Pb-FREE	MSL LEVEL	HALOGEN FREE	GRADE	TOP MARK
SOT28E7A-TIN	N/A	DUMMY	YES	3	NO	COMMERCIAL	N/A
SOT28E7A-T-ISO	NONE	FULLY ISOLATED	YES	3	YES	COMMERCIAL	ISO
SOT28E7A-T-DC18D	1~2, 3~4 5~6, 7~8	4-WIRE	YES	3	YES	COMMERCIAL	18D
SOT28E7A-T-DC28D	1~8, 2~7 3~6, 4~5	4-WIRE	YES	3	YES	COMMERCIAL	28D
SOT28E7A-T-DC30D	1~2~3~4	3-WIRE	YES	3	YES	COMMERCIAL	30D

TopLine®			
TITLE		SOT28 JUMPER DAISY CHAIN	
SCALE	SIZE A	DRAWING NO. 120028	REV A
DO NOT SCALE DRAWING			SHEET 4 OF 8

TAPE SPECIFICATION FOR SOT-28 SURFACE MOUNT DEVICE

SOT-28 PACKAGE REEL

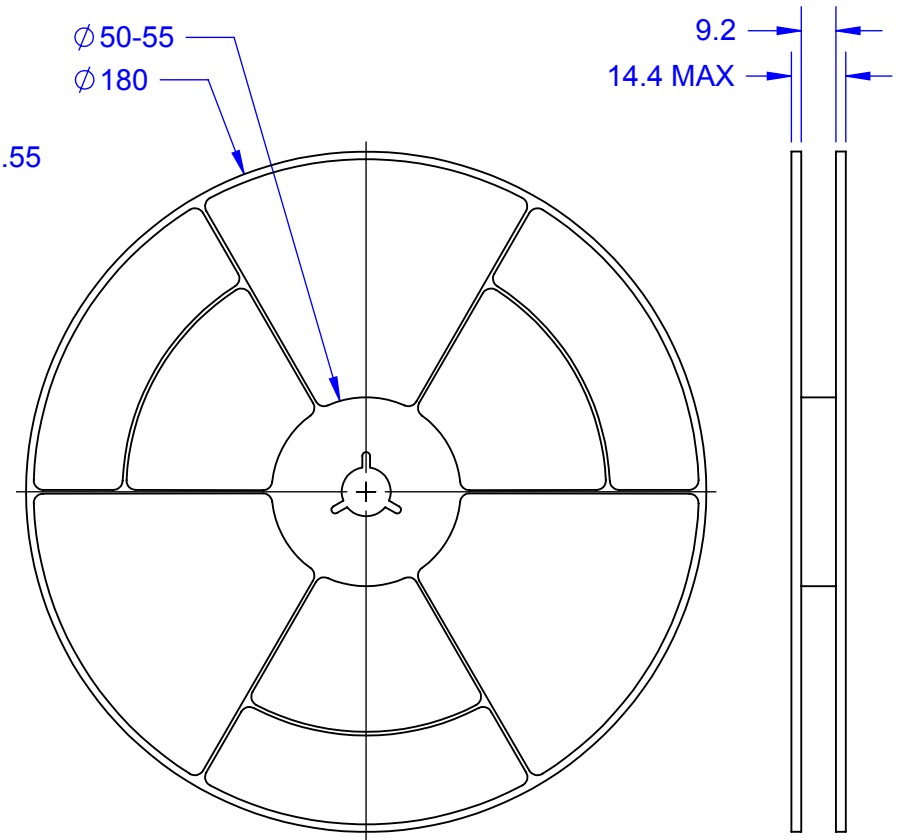
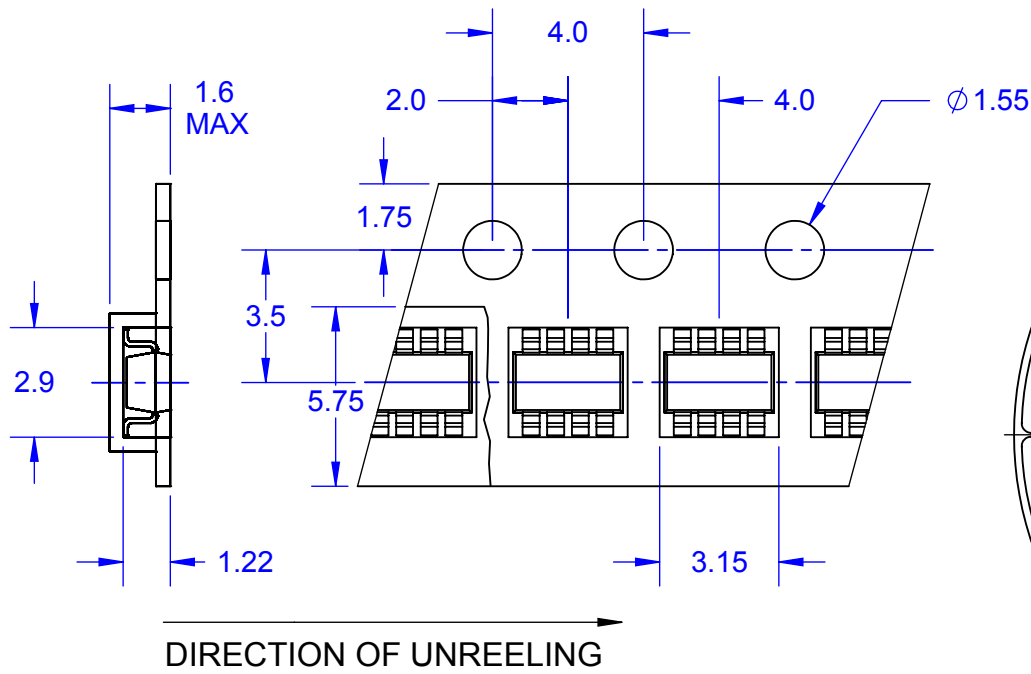

8mm TAPE
SIZE OF REEL
180mm (7")
3,000 PCS

Notes: (Unless Otherwise Specified).
1) DIMENSIONS IN mm.

TopLine[®]			
TITLE		SOT28 JUMPER DAISY CHAIN	
SCALE	SIZE	DRAWING NO.	REV
5:1	A	120028	A
DO NOT SCALE DRAWING			SHEET 5 OF 8

**MATERIALS CONTENT DECLARATION FORM
SOT28 PACKAGE MASS 15.9mg**

COMPONENT	MATERIAL	MATERIAL		SUBSTANCE	CAS NO.	SUBSTANCE		
		(%wt)	(mg)			(%wt)	(mg)	(ppm)
ACTIVE DEVICE	DOPED Si	4.4%	0.7	Si	7440-21-3	4.4%	0.7	43,986
BOND WIRE	GOLD	1.07%	0.17	Au	7440-57-5	1.07%	0.17	10,682
LEADFRAME	Cu ALLOY w/ SILVER PLATING	46.48%	7.4	Cu	7440-50-8	44.87%	7.14	448,662
				Fe	7439-89-6	1.07%	0.17	10,682
				Zn	7440-66-6	0.08%	0.012	754
				Ag	7440-22-4	0.47%	0.075	4,713
DIE ATTACH	SILVER EPOXY	0.69%	0.11	Ag	7440-22-4	0.55%	0.088	5,530
				EPOXY RESIN	PROPIETARY	0.14%	0.022	1,382
ENCAPSULATION*	EMC GREEN	43.9%	6.99	SILICA	7631-86-9	36.13%	5.75	361,317
				EPOXY RESIN	29690-82-2	3.2%	0.51	32,047
				PHENOL RESIN	9003-35-4	2.26%	0.36	22,622
				CARBON BLACK	1333-86-4	0.08%	0.012	754
				METAL HYDROXIDE	1309-42-8	2.23%	0.355	22,307
PLATING	MATTE TIN	3.46%	0.55	Sn	7440-31-5	3.46%	0.55	34,561

*EMC GREEN MOLDING COMPOUND IS HALOGEN-FREE.

TopLine®			
TITLE		SOT28 JUMPER DAISY CHAIN	
SCALE	SIZE A	DRAWING NO. 120028	REV A
DO NOT SCALE DRAWING			SHEET 6 OF 8

PC BOARD LAND PATTERN

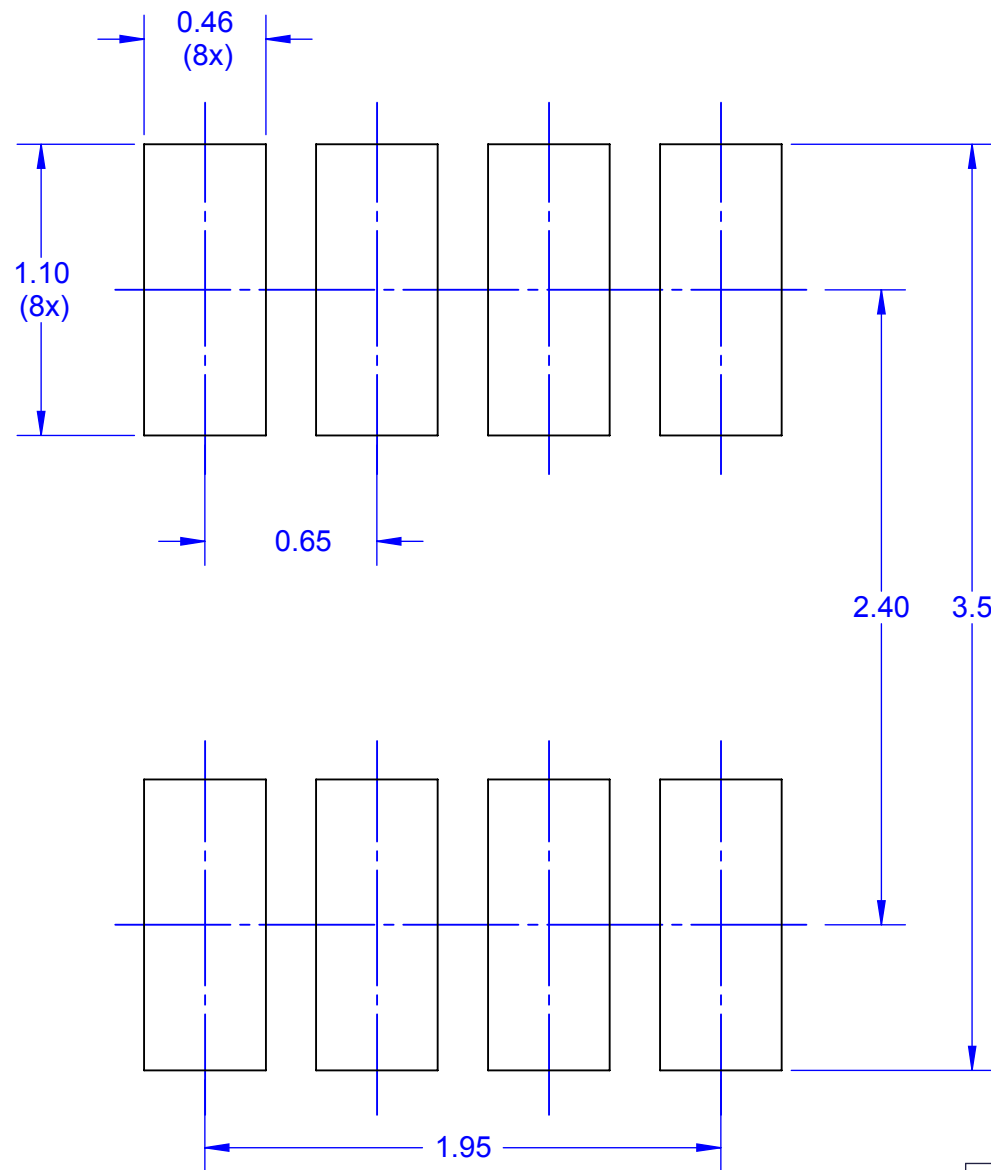

Notes: (Unless Otherwise Specified).

1) DIMENSIONS IN mm.

2) PCB BOARD DIMENSIONS ARE PRESENTED ONLY AS A GUIDELINE
DESIGNER SHOULD USE THEIR OWN EXPERIENCE WHEN DESIGNING PCB.

TopLine[®]

TITLE SOT28 JUMPER
DAISY CHAIN

SCALE 35:1	SIZE A	DRAWING NO. 120028	REV A
---------------	-----------	-----------------------	----------

DO NOT SCALE DRAWING

SHEET 7 OF 8

LEAD FREE REFLOW PROFILE

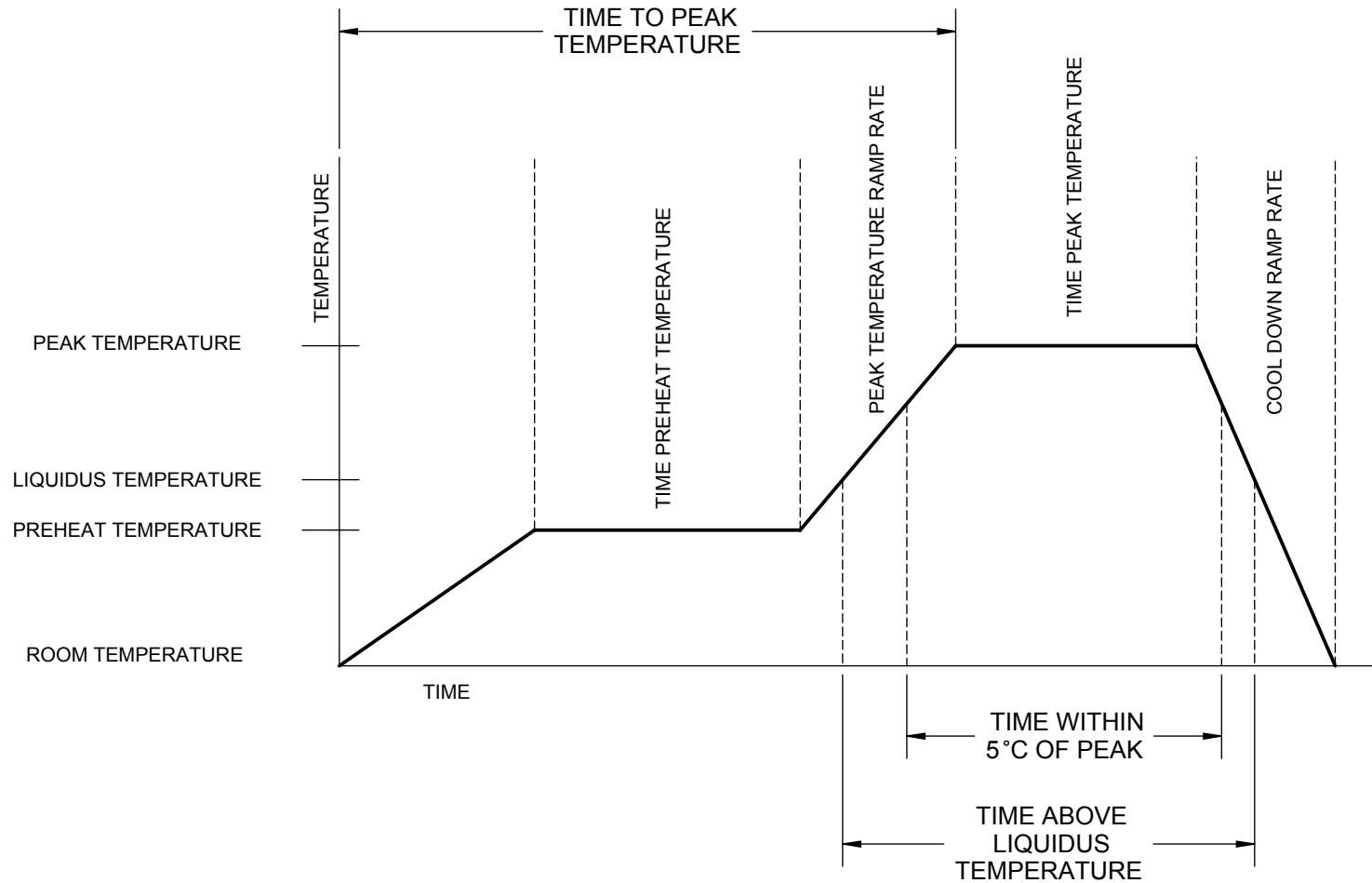

DESCRIPTION	REQUIREMENT
AVERAGE PREHEAT RAMP RATE	3°C /SECOND MAXIMUM
PREHEAT TEMPERATURE	150°C MINIMUM, 200°C MAXIMUM
PREHEAT TIME	60 TO 80 SECONDS
RAMP TO PEAK	3°C /SECOND MAXIMUM
TIME OVER LIQUIDUS (217°C)	60 TO 150 SECONDS
PEAK TEMPERATURE	260°C +0/-5°C
TIME WITHIN 5°C OF PEAK	20 TO 40 SECONDS
RAMP - COOL DOWN	6°C /SECONDS MAXIMUM
TIME 25°C TO PEAK	8 MINUTES MAXIMUM

TopLine®			
TITLE		SOT28 JUMPER DAISY CHAIN	
SCALE	SIZE	DRAWING NO.	REV
	A	120028	A
DO NOT SCALE DRAWING			SHEET 8 OF 8