

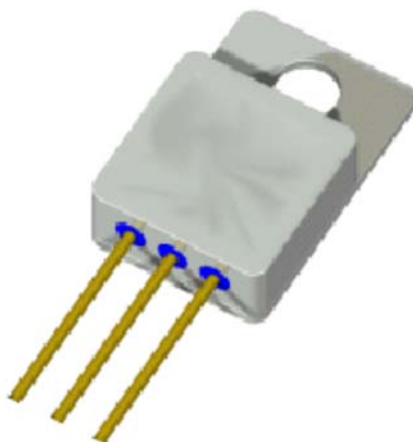

**Contact Us:**  
Tel: 1-800-776-9888  
[sales@TopLine.tv](mailto:sales@TopLine.tv)  
[www.TopLine.tv](http://www.TopLine.tv)

**T0257**  
**JEDEC TO-257AA Package**  
**TopLine Dummy Component**  
**For training, practice and evaluation**



**Quick Specs:**

Pin Count 3L  
Pitch 0.150" (3.81mm)  
Body 0.415"x0.415"x0.19"  
Flange 0.65L"x.415W"  
Metal Body

**Use and Applications:**

IPC Solder Training & Practice  
Equipment Evaluation  
Prototype PWB

**Availability:**

Delivery Stock to 4 weeks

**Part Numbers:**

TO257 = Ni Plated  
TO257-GOLD = Au Plated

[See Page 2 for Outline Drawing](#)

## Part Numbering System

T0257 - Option

Jedec Series - Plating

Metal Case - Blank = Nickel  
GOLD = Au

Options: open **Headers and cans** available for packaging live die

State your die size requirement.

**TopLine Corporation**  
95 Highway 22 W  
Milledgeville, GA 31061, USA  
**Toll Free** USA/Canada (800) 776-9888  
International: 1-478-451-5000 • Fax: 1-478-451-3000  
Email: [sales@topline.tv](mailto:sales@topline.tv)

# TO-257AA Package TopLine

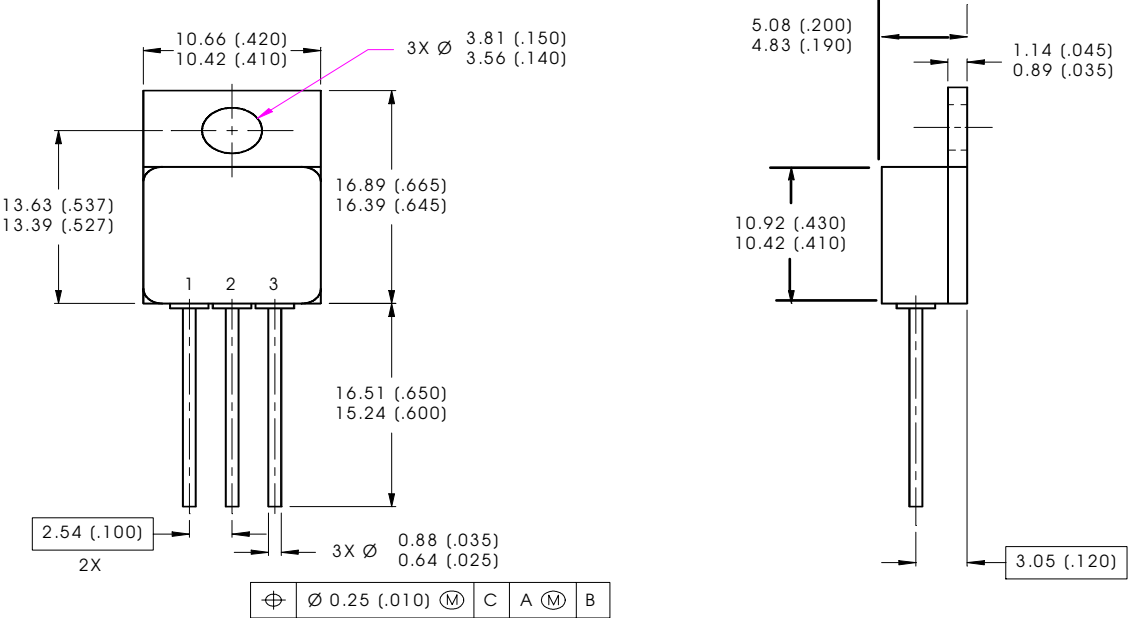

- NOTES:
1. DIMENSIONING & TOLERANCING PER ANSI Y14.5M-1994.
  2. CONTROLLING DIMENSION: INCH.
  3. DIMENSIONS ARE SHOWN IN MILLIMETERS (INCHES).
  4. OUTLINE CONFORMS TO JEDEC OUTLINE TO-257AA.