

DIMENSION METRIC (mm)

TOP

SIDE VIEW

END VIEW

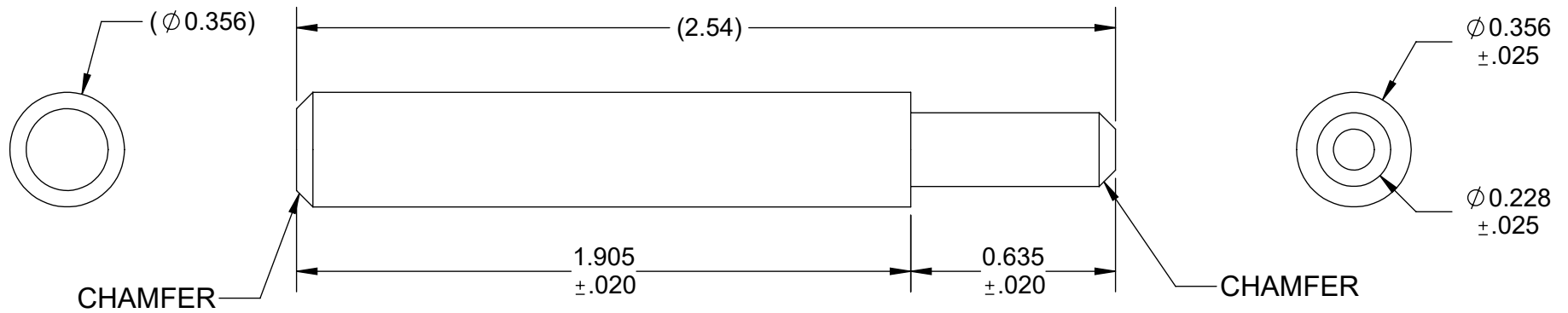

TO HOUSING

MODEL

TO SPRING

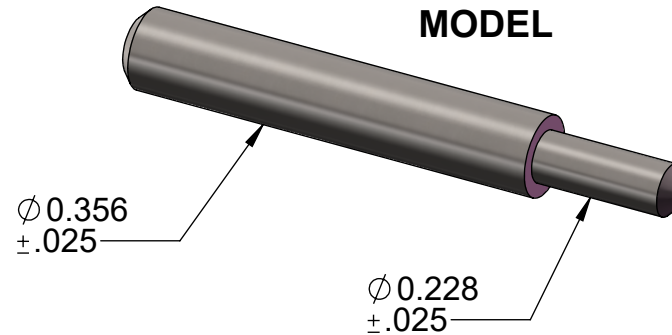

NOTES:

- 1) DIMENSIONS IN MM (UNLESS OTHERWISE SPECIFIED).
- 2) TOLERANCE TO BE DEFINED.
- 3) MATERIAL: TITANIUM (Ti) GRADE 2.
- 4) ONE PIECE CONSTRUCTION.

APPROVALS	DATE	TopLine®			
DRAWN T. Au	4/15/2020				
ENG M. Hart	4/15/2020	TITLE Ti SHOULDER PIN 14x100-A TAMPING TOOL MCS 16x40			
MFG		SCALE	SIZE	DRAWING NO.	REV
QA		32:1	A	161840	A
CUST		DO NOT SCALE DRAWING			SHEET 1 OF 3
REVISED					

DIMENSION (Inch)

TOP

SIDE VIEW

END VIEW

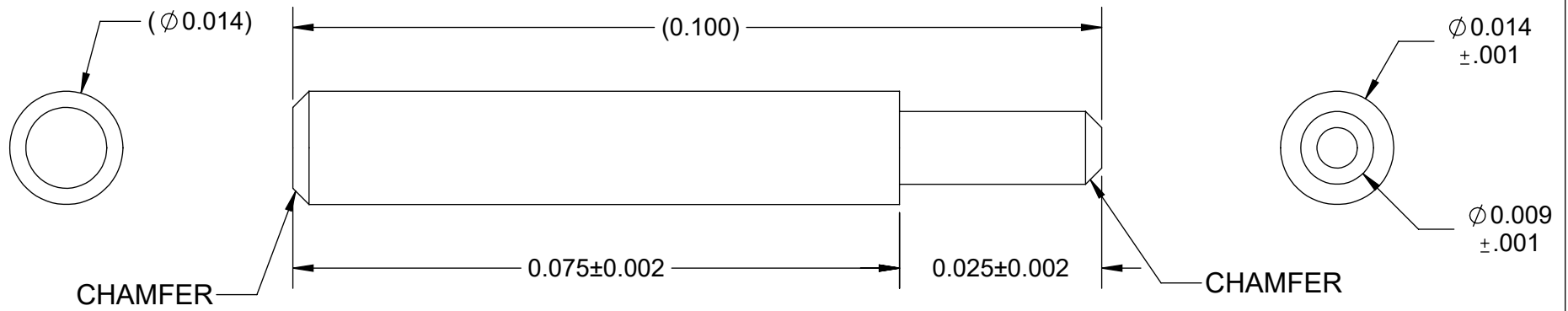

TO HOUSING

MODEL

TO SPRING

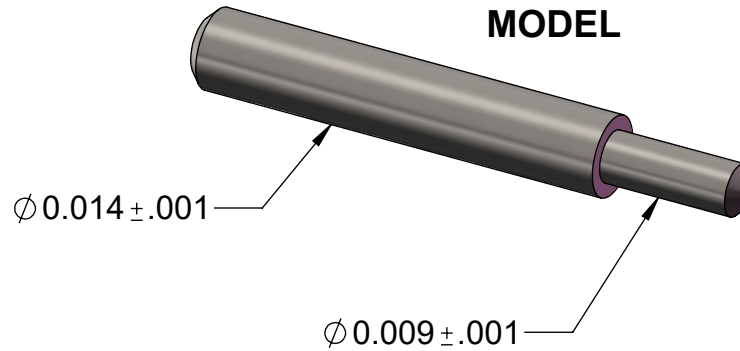

NOTES:

- 1) DIMENSIONS IN INCH (UNLESS OTHERWISE SPECIFIED).
- 2) TOLERANCE TO BE DEFINED.
- 3) MATERIAL: TITANIUM (Ti) GRADE 2.
- 4) ONE PIECE CONSTRUCTION.

APPROVALS	DATE	TopLine®			
DRAWN T. Au	4/15/2020				
ENG M. Hart	4/15/2020	TITLE Ti SHOULDER PIN 14x100-A TAMPING TOOL MCS 16x40			
MFG		SCALE	SIZE	DRAWING NO.	REV
QA		32:1	A	161840	A
CUST		DO NOT SCALE DRAWING			SHEET 2 OF 3
REVISED					



TOP

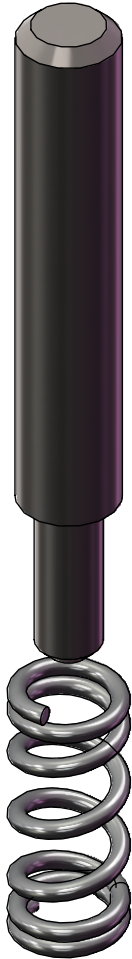

PERSPECTIVE



BOTTOM

TopLine[®]

TITLE Ti SHOULDER PIN 14x100-A
TAMPING TOOL MCS 16x40

SCALE	SIZE	DRAWING NO.	REV
32:1	A	161840	A

DO NOT SCALE DRAWING

SHEET 3 OF 3